

YFCN Fan Coil Unit centrifugal fan

2 & 4 pipe system

A complete range from 1.0 kW to 7.6 kW



Wired controls



BR
Remote three speeds controller

TR
BR + Electronic thermostat
and Summer/Winter switch

ATR
Automatic TR



DTR
Digital Automatic
Remote controller

TMO 503 SV2
Digital Automatic
Remote controller
to be mounted in the standard
light wall box

DRC - DI
Centralized controller
up to 60 terminals



Infrared control

Features

- New Casing, improved aesthetics and suitable for any modern indoor ambient
- Full range for all your needs: 9 sizes suitable for horizontal/vertical mounting
- Models with or without casing
- Low noise operation
- 3 fan speeds (possible to choice between 6 fan speeds)
- Single piece discharge grid
- Several coil choices: Single: 3 or 4 rows, Dual: 3 rows cooling & 2 rows heating
- Electrical heater optional
- Suction and discharge plenum optional
- Factory fitted valves and controller packages
- Painted back panel option
- 4 available versions in all range:
 - VC = Vertical Discharge with Casing
 - VCB = Vertical Discharge with Casing (floor installation)
 - HC = Horizontal Discharge with Casing
 - CD = Concealed unit without Casing



**FX03 Terminal unit
controller**
BacNET and N2 Metasys
network compatible

YFCN Fan Coil Unit centrifugal fan

1.0 to 7.6 kW

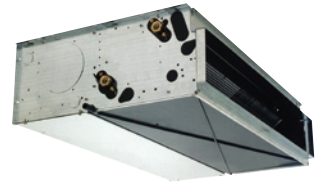

YFCN - Technical features 2 pipes

YFCN model	Air flow m³/h	Total capacity		Pressure drop		Power input W	Pressure level dBA	Dimensions (with casing)		
		Cooling kW	Heating kW	Cooling kPa	Heating kPa			Height mm	Width mm	Depth mm
130	220	1.0	1.4	2.3	2.0	33	36	530	670	225
230	295	1.6	2.0	6.5	5.5	32	38	530	770	225
330	385	2.4	2.9	19.7	16.7	41	40	530	985	225
430	485	2.9	3.6	27.2	23.1	44	38	530	985	225
530	650	3.2	3.9	12.7	10.8	46	34	530	1 200	225
630	760	4.1	5.1	19.8	16.8	78	43	530	1 200	225
730	925	5.1	6.3	34.2	29.1	103	47	530	1 415	225
830	1 200	5.8	7.7	19.0	16.2	130	51	530	1 415	255
930	1 500	6.7	9.1	24.6	20.9	176	55	530	1 415	255
140	220	1.2	1.6	5.6	4.7	33	36	530	670	225
240	295	1.8	2.2	13.9	11.6	32	38	530	770	225
340	385	2.6	3.1	11.5	9.2	41	40	530	985	225
440	485	3.1	3.8	15.5	12.2	44	38	530	985	225
540	545	3.5	4.2	24.2	19.9	46	34	530	1 200	225
640	760	4.8	5.9	36.2	29.3	78	43	530	1 200	225
740	925	5.6	6.7	27.7	23.7	103	47	530	1 415	225
840	1 200	6.5	8.4	17.5	14.5	130	51	530	1 415	255
940	1 500	7.6	10.1	23.2	19.3	176	55	530	1 415	255

With fan running at max. speed. Data for the casing models. The capacities are accordingly to the EUROVENT standards and UNI ENV 1397.

COOLING: Room temperature 27°C d.b., 19°C w.b. - Water temperature 7/12 °C

HEATING: Room temperature 20°C - Water inlet temperature: 50°C and water flow rate is for a cooling conditions

* The sound pressure levels are 9 dB(A) lower than the sound power levels and apply to the reverberant field of a 100 m³ room and a reverberation time of 0.5 sec.

YFCN - Technical features 4 pipes

YFCN model	Air flow m³/h	Total capacity		Pressure drop		Power input W	Pressure level dBA	Dimensions (with casing)		
		Cooling kW	Heating kW	Cooling kPa	Heating kPa			Height mm	Width mm	Depth mm
130-1	220	1.0	1.0	2.3	1.7	33	36	530	670	225
230-1	295	1.6	1.5	6.5	4.0	32	38	530	770	225
330-1	385	2.4	2.3	19.7	9.7	41	40	530	985	225
430-1	485	2.9	2.7	27.2	12.8	44	38	530	985	225
530-1	545	3.2	3.0	12.7	3.2	46	34	530	1 200	225
630-1	760	4.1	3.8	19.8	6.7	78	43	530	1 200	225
730-1	925	5.1	4.8	34.2	8.3	103	47	530	1 415	225
830-1	1 200	5.8	5.4	19.0	10.3	130	51	530	1 415	255
930-1	1 500	6.7	6.2	24.6	13.2	176	55	530	1 415	255

With fan running at max. speed. Data for the casing models. The capacities are accordingly to the EUROVENT standards and UNI ENV 1397.

COOLING: Room temperature 27°C d.b., 19°C w.b. - Water temperature 7/12 °C

HEATING: Room temperature 20°C - Water inlet temperature: 70/60°C

* The sound pressure levels are 9 dB(A) lower than the sound power levels and apply to the reverberant field of a 100 m³ room and a reverberation time of 0.5 sec.

Options / Accessories

Compatibility table / Codes

Model	YFCN		
	VC/VCB mod. - Vertical with casing	HC mod. - Horizontal with casing	CD mod. - Without casing
Controls for style VC (supplied with separate packaging)			
Three speed control BL *	9060130	-	-
Three speed control + electronic thermostat and S/W switch TMV-S	9060140	-	-
Three speed control + electronic thermostat and centralized S/W - TLC **	9060133	-	-
Automatic speed control with electronic thermostat and S/W switch ATL **	9060134	-	-
Infra-red remote control with fitted electronic board for versions VC and HC only IRC-M **	9060175	9060175	-
IRC-M control (fitted on the unit) with ETN +/- 3%	9060166	9060166	9060166
Controls for style HC/CD (supplied with separate packaging)			
Remote three speed control BR *	-	9060540	9060540
Remote three speed control + electronic thermostat and S/W switch TR ***	-	9060541	9060541
Automatic speed control with electronic thermostat and centralized S/W - ATR ***	-	9060542	9060542
Automatic remote control with electronic thermostat, S/W switch and liquid crystall display DTR **	-	9060521	9060521
Automatic speed control with electronic thermostat to be mounted in the light wall box TMO-503-S ****	-	9060170	9060170
Automatic speed control with electronic thermostat to be mounted in the light wall box TMO-503-SV ****	-	9060172	9060172
Infra-red remote control with NOT fitted electronic board for version CD only IRC-S **	-	-	9060176
IRC-S control (not fitted on the unit) with ETN +/- 3%	-	9060167	9060167
Controls for all versions (supplied with separate packaging)			
Low temperature cut out TME for controls TL, TLC, ATL, ATLC, TR, DTR	3021091	3021091	3021091
Low temperature cut out TMM for controls BL, BR	9053048	9053048	9053048
Change over 15-25 CH 15-25	9053049	9053049	9053049
Receiving speed selector for centralized control (slave) style VC RECV	9060136	9060136	9060136
Receiving speed selector for centralized control (slave) style HC/CD RECH	9060137	9060137	9060137
Receiver (slave) for control DTR RECD	9060139	9060139	9060139
Digital remote control up to 60 multifunction units	9079102	9079102	9079102
Controls for style VC + additional electric resistance (supplied with separate packaging)			
Three speed control BL-E *	9063000	-	-
Three speed control + electronic thermostat and S/W switch BTL-E *	9063001	-	-
Three speed control + electronic thermostat and S/W switch TL-E **	9063002	-	-
Three speed control + electronic thermostat and centralized S/W - TLC-E **	9063003	-	-
Automatic speed control with electronic thermostat and S/W switch ATL-E **	9063004	-	-
Automatic speed control with electronic thermostat and centralized S/W - ATLC-E **	9063005	-	-
Controls for style HC/CD + additional electric resistance (supplied with separate packaging)			
Remote three speed control BR-E *	-	9063050	9063050
Remote three speed control + electronic thermostat and S/W switch TR-E ***	-	9063051	9063051
Automatic speed control with electronic thermostat and centralized S/W - ATR-E ***	-	9063024	9063024
Automatic remote control with electronic thermostat, S/W switch and liquid crystall display DTR **	-	9060521	9060521

* not to be used with valves and/or low temperature cut-out

** it can be used with valves and/or low temperature cut-out

*** to be used with valves and/or low temperature cut-out. The Winter/Summer switch is manual/centralized in accordance to the position of the J1 Jumper

**** low temperature cut-out included

Options / Accessories

Compatibility table / Codes

Model	YFCN								
	130/140	230/240	330/340	430/440	530/540	630/640	730/740	830/840	930/940
Valves									
Kit 3 way valve mounted			9066561					9060471	
Kit 3 way valve additional battery mounted					9060472				
Kit 3 way valve not mounted			9066560					9060474	
Kit 3 way valve additional battery not mounted					9060475				
Kit 2 way valve primary + additional battery mounted			9060476					-	
Kit 2 way valve primary battery mounted			-					9060477	
Kit 2 way valve primary+additional battery not mounted			9060478					-	
Kit 2 way valve primary battery not mounted			-					9060479	
Simplified valve kit for CD version fitted			9066571					9060484	
Simplified valve kit for CD version not fitted			9066570					9060481	
Accessories for all versions									
Pair feet					9060150				9060151
Vertical auxiliary condensate tray						6060400			
Horizontal auxiliary condensate tray (left connections)						6060402			
Horizontal auxiliary condensate tray (right connections)						6060403			
Condensate drain pipe						6060420			
El. resistance and relays fitted on the unit (650 W) VC/HC	9066491E					-			
El. resistance and relays fitted on the unit (400 W) VC/HC	-	9066472E				-			
El. resistance and relays fitted on the unit (600 W) VC/HC	-	9066482E		9066473E				-	
El. resistance and relays fitted on the unit (750 W) VC/HC						9066475E			-
El. resistance and relays fitted on the unit (900 W) VC/HC	-			9066483E				-	
El. resistance and relays fitted on the unit (1000 W) VC/HC	-	9066492E							9066477E
El. resistance and relays fitted on the unit (1250 W) VC/HC						9066485E			-
El. resistance and relays fitted on the unit (1500 W) VC/HC	-			9066493E					9066487E
El. resistance and relays fitted on the unit (2000 W) VC/HC						9066495E			-
El. resistance and relays fitted on the unit (2500 W) VC/HC									9066497E
El. resistance and relays fitted on the unit (700 W) CD	9066611E					-			
El. resistance and relays fitted on the unit (400 W) CD	-	9066592E						-	
El. resistance and relays fitted on the unit (600 W) CD	-	9066602E		9066593E					-
El. resistance and relays fitted on the unit (750 W) CD						9066595E			-
El. resistance and relays fitted on the unit (900 W) CD				9066603E					-
El. resistance and relays fitted on the unit (1000 W) CD	-	9066612E							9066597E
El. resistance and relays fitted on the unit (1250 W) CD						9066605E			-
El. resistance and relays fitted on the unit (1500 W) CD				9066613E					9066607E
El. resistance and relays fitted on the unit (2000 W) CD						9066615E			-
El. resistance and relays fitted on the unit (2500 W) CD									9066617E
Damper	9066531	9066532	9066533		9066535	9066537		9066538	
IM Frame	-	9060575	9060576		9060577	9060578		-	
Rear closing panel VC	9062005	9060180	9060181		9060182			9060183	
Rear closing panel HC	9060187	9060190	9060191		9060192	9060193		9060194	
Frontal air intake CD mounted	9066501	9066502	9066503		9066505	9066507		9066508	
Intake grid for VC	9060229	9060230	9060231		9060232			9060233	
Adaptor for terminal board VC for remote control					9060103				
Accessories only for concealed version CD									
Outlet flange 90°	9066381	9066382	9066383		9066385	9066387		9066388	
Inlet flange 90°	9066441	9060710	9060711		9060712	9060713		9060714	
Straight inlet flange	9066451	9060720	9060721		9060722	9060723		9060724	
Straight outlet flange	9066371	9066372	9066373		9066375	9066377		9066378	
Outlet spigot diffuser	9066361	9066362	9066363		9066365	9066367		9066368	
Air outlet grid	9066411	9060750	9060751		9060752			9060753	
Air inlet grid	9066421	9060760	9060761		9060762			9060763	
Air inlet spigot plenum	9066461	9066462	9066463		9066465	9066467		9066468	
Intake grid with filter (to be used in combination with inlet flange 90°)	9066391	9060770	9060771		9060772			9060773	
Intake grid with filter (to be used in combination with straight inlet flange)	9066401	9060774	9060775		9060776			9060777	

Dimensions

YFCN 130 to 940 (with casing)

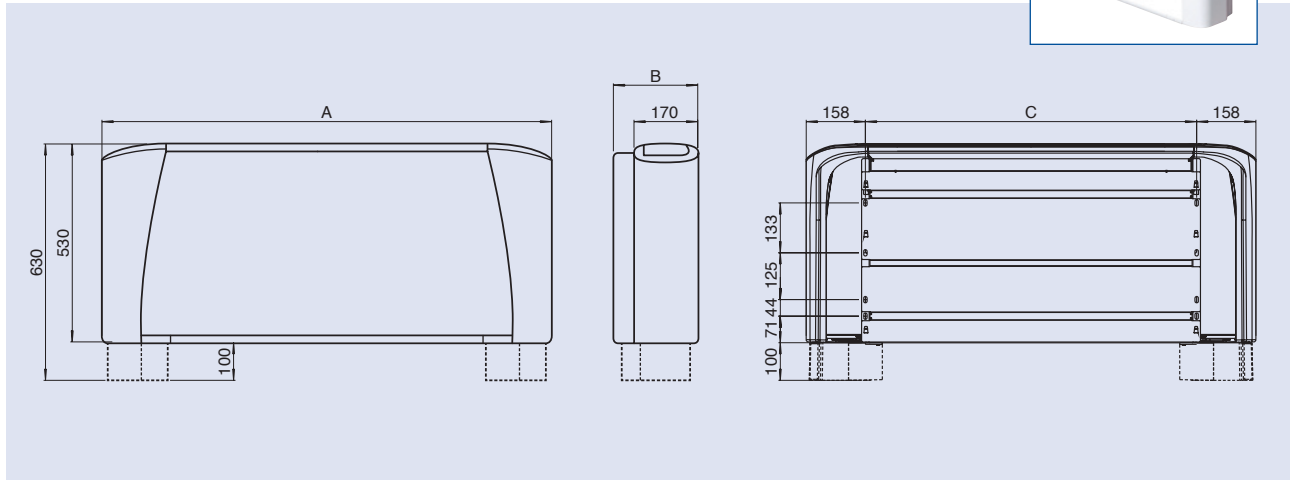

All dimensions in mm. Drawings not a scale.

Model	130 / 140	230 / 240	330 / 340	430 / 440	530 / 540	630 / 640	730 / 740	830 / 840	930 / 940
A	670	770	985	985	1 200	1 200	1 415	1 415	1 415
B	225	225	225	225	225	225	225	255	255
C	354	454	669	669	884	884	1 099	1 099	1 099

YFCN 130 to 940 (without casing)

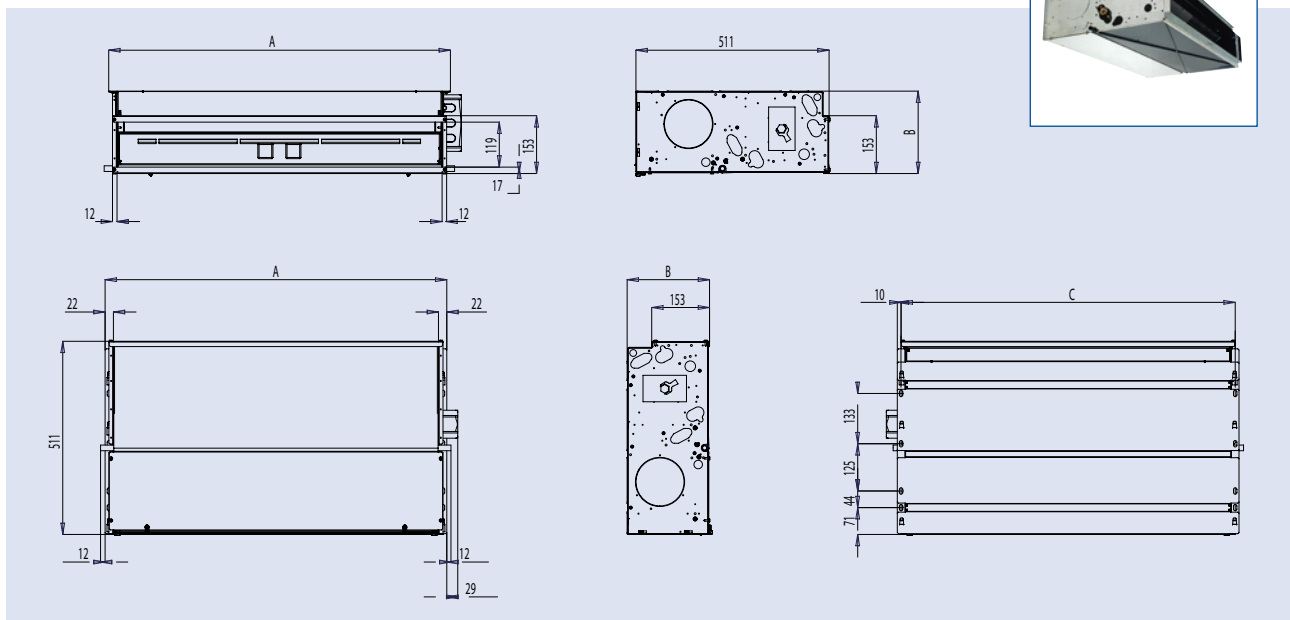

All dimensions in mm. Drawings not a scale.

Model	130 / 140	230 / 240	330 / 340	430 / 440	530 / 540	630 / 640	730 / 740	830 / 840	930 / 940
A	374	474	689	689	904	904	1 119	1 119	1 119
B	218	218	218	218	218	218	218	248	248
C	354	454	669	669	884	884	1 099	1 099	1 099